

REVISIONS			
REV.	DESCRIPTION	DATE	APPROVED
B	REVISED	6-28-12	RGB

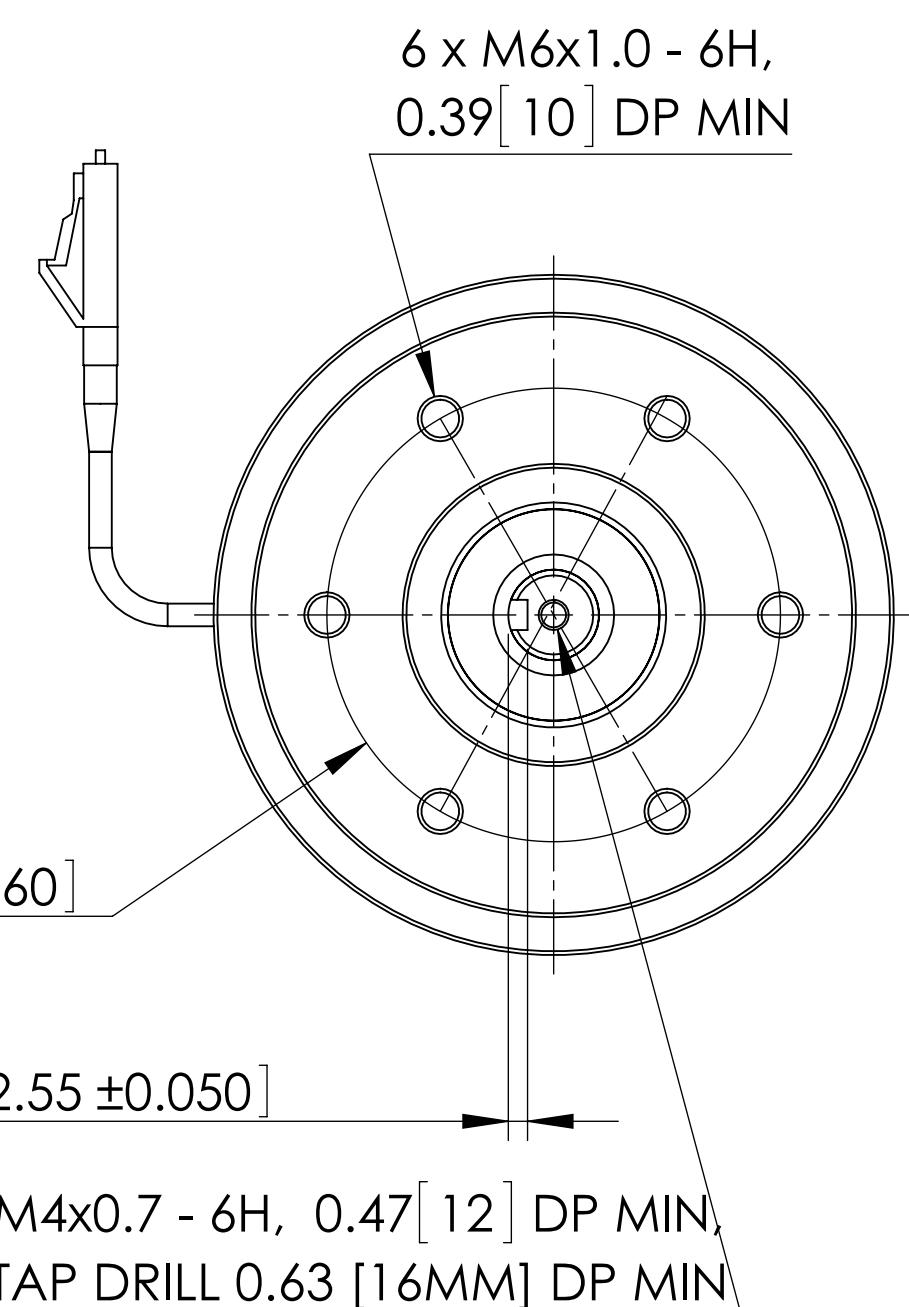
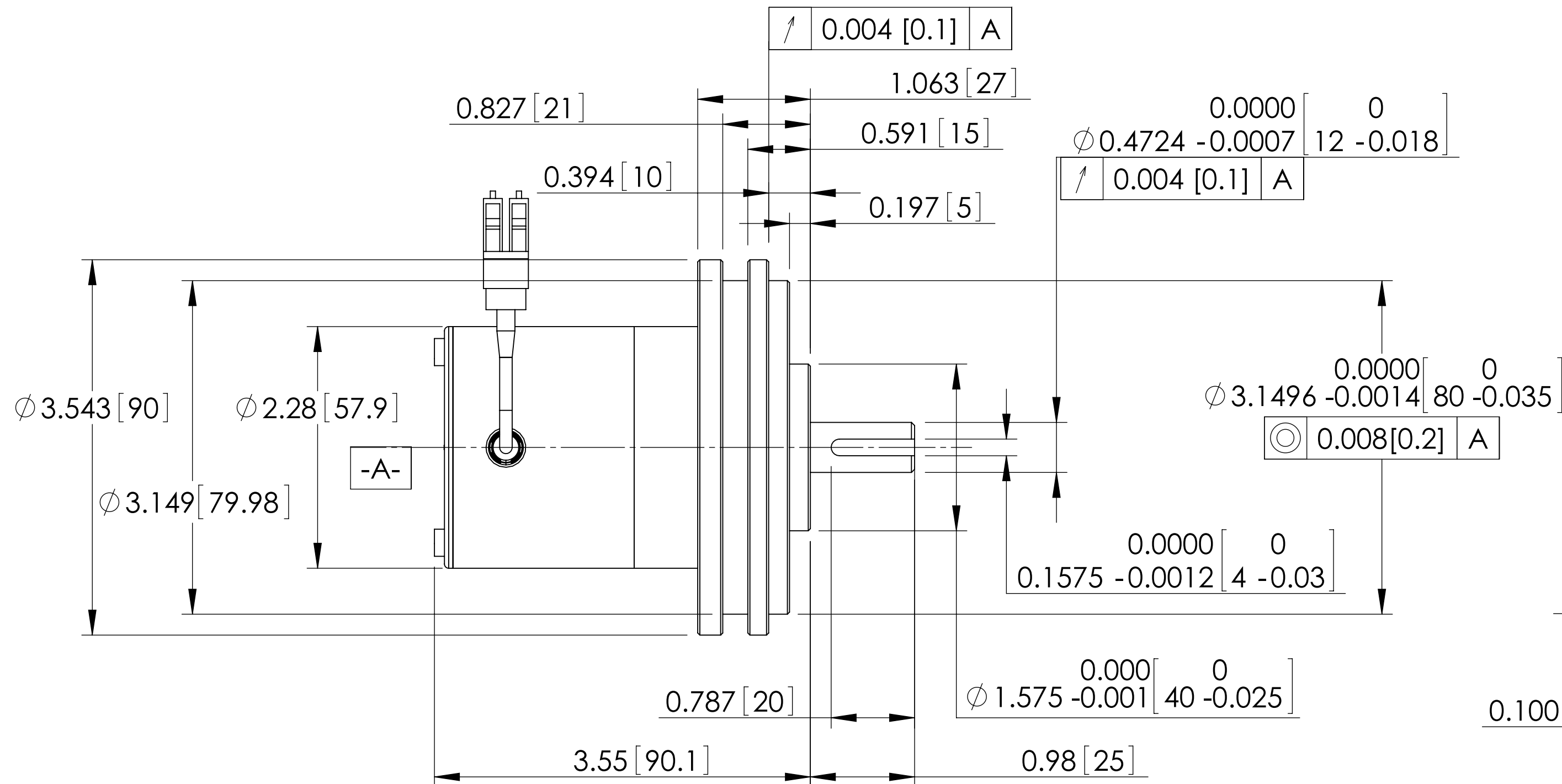

PART NUMBER ORDERING CODE

MR326 - C 12 C 1R5

RESOLUTION
C = 256

SHAFT SIZE IN MILLIMETERS
12 = 12MM SHAFT
OTHER SHAFT OPTIONS ARE AVAILABLE

CONNECTOR TYPE
C = DUPLEX LC

PIGTAIL LENGTH IN METERS
(R = DECIMAL POINT)
1R5 = 1.5 METER

TEMPERATURE RANGE
(BLANK) = STANDARD
(-40 °C TO +80 °C)

- 3 WARNING: KEEP CONNECTOR COVERS IN PLACE DURING STORAGE, TO PROTECT FIBER OPTIC INTERFACES.
- 2 WARNING: DO NOT DROP UNIT. DROPPING OR OTHER SEVERE SHOCK IMPACTS MAY DAMAGE UNIT.
- 1 ALWAYS USE FLEXIBLE COUPLING WHEN MOUNTING SHAFT TO EXTERNAL EQUIPMENT.

NOTES: UNLESS OTHERWISE SPECIFIED

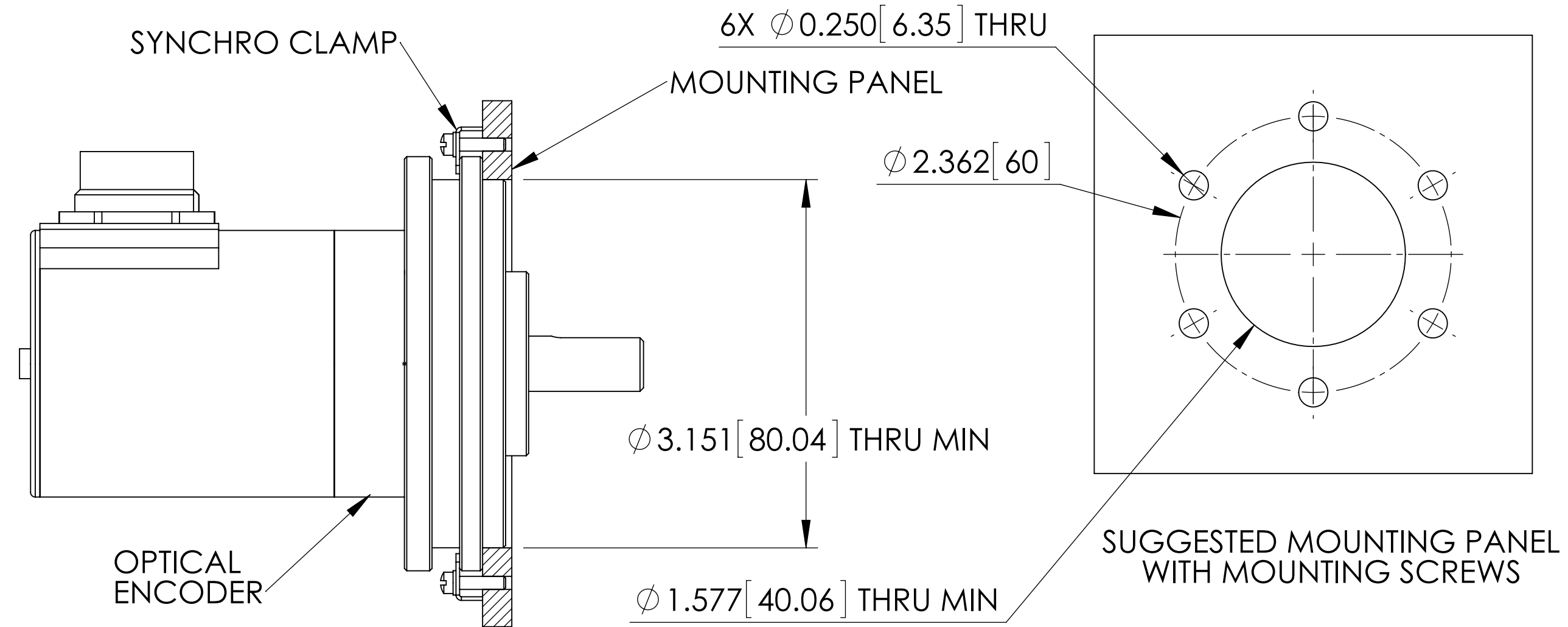

SUGGESTED MOUNTING PANEL WITH SERVO CLAMPS

UNLESS OTHERWISE SPECIFIED: DIMENSIONS ARE IN INCHES TOLERANCES: ANGULAR: ± .5° TWO PLACE DECIMAL ± .02 THREE PLACE DECIMAL ± .005 FOUR PLACE DECIMAL ± .0010	DRAWN	NAME	DATE	MICRONOR INC. NEWBURY PARK, CA (805) 499-0114
	CHECKED	R BOYER	6-21-05	
	ENG APPR.			
	MFG APPR.			
INTERPRET GEOMETRIC TOLERANCING PER:	Q.A.			TITLE:
MATERIAL	COMMENTS:			SENSOR, 90MM, DUPLEX LC
FINISH	SEE NOTES			SIZE
DO NOT SCALE DRAWING	SEE NOTES			DWG. NO.
				MR326-CXXCXXX
				REV
				B
				SCALE: 1:1
				WEIGHT:
				SHEET 1 OF 1

PROPRIETARY AND CONFIDENTIAL
THE INFORMATION CONTAINED IN THIS DRAWING IS THE SOLE PROPERTY OF MICRONOR CORPORATION. ANY REPRODUCTION IN PART OR AS A WHOLE WITHOUT THE WRITTEN PERMISSION OF MICRONOR CORPORATION IS PROHIBITED.

REVISIONS			
REV.	DESCRIPTION	DATE	APPROVED
A	NEW RELEASE	6-28-12	RGB

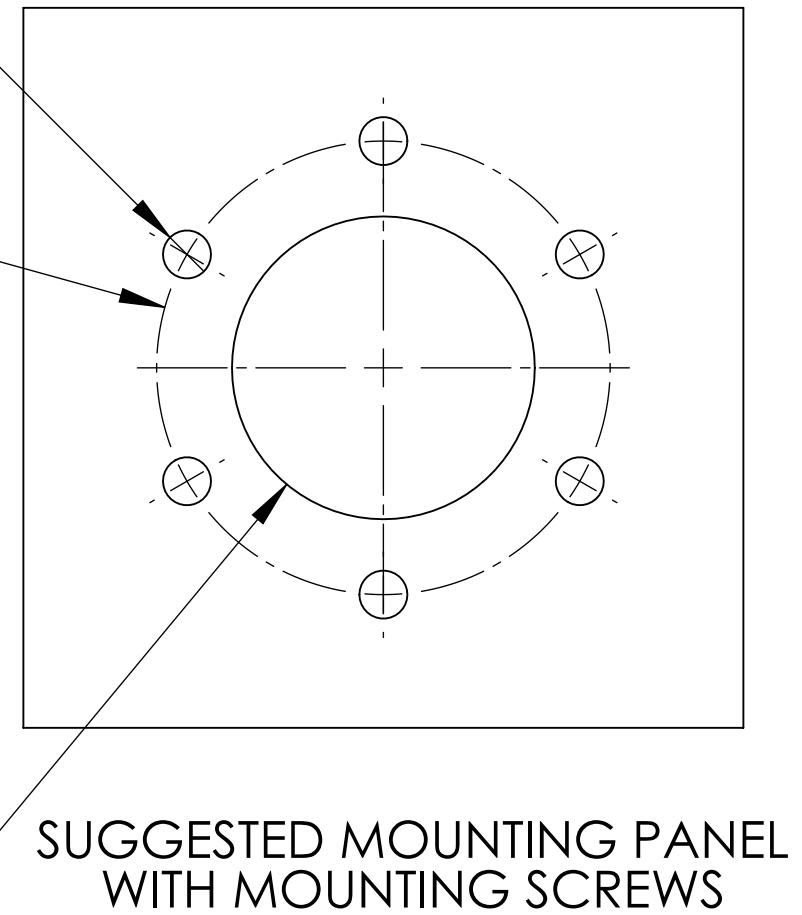
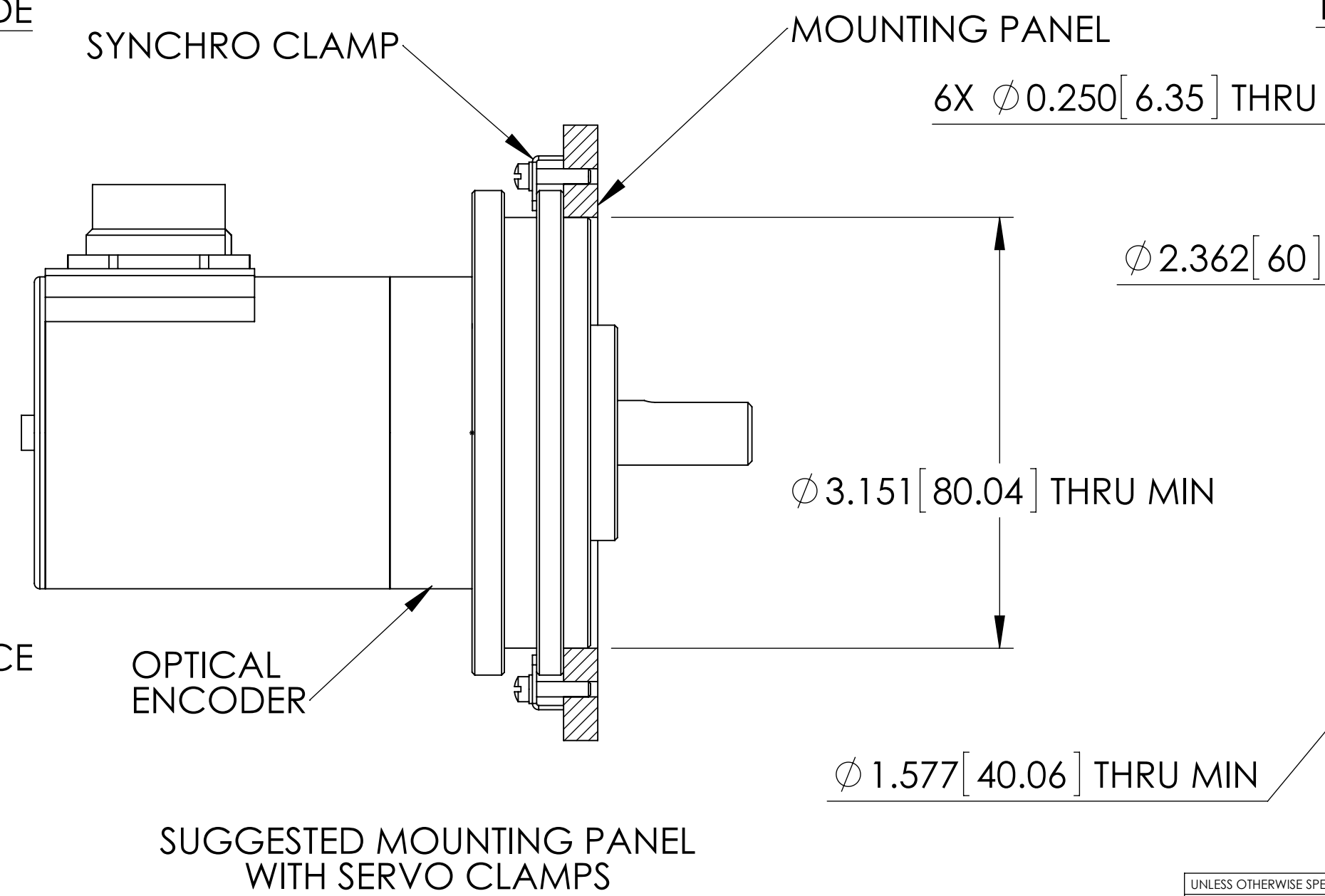
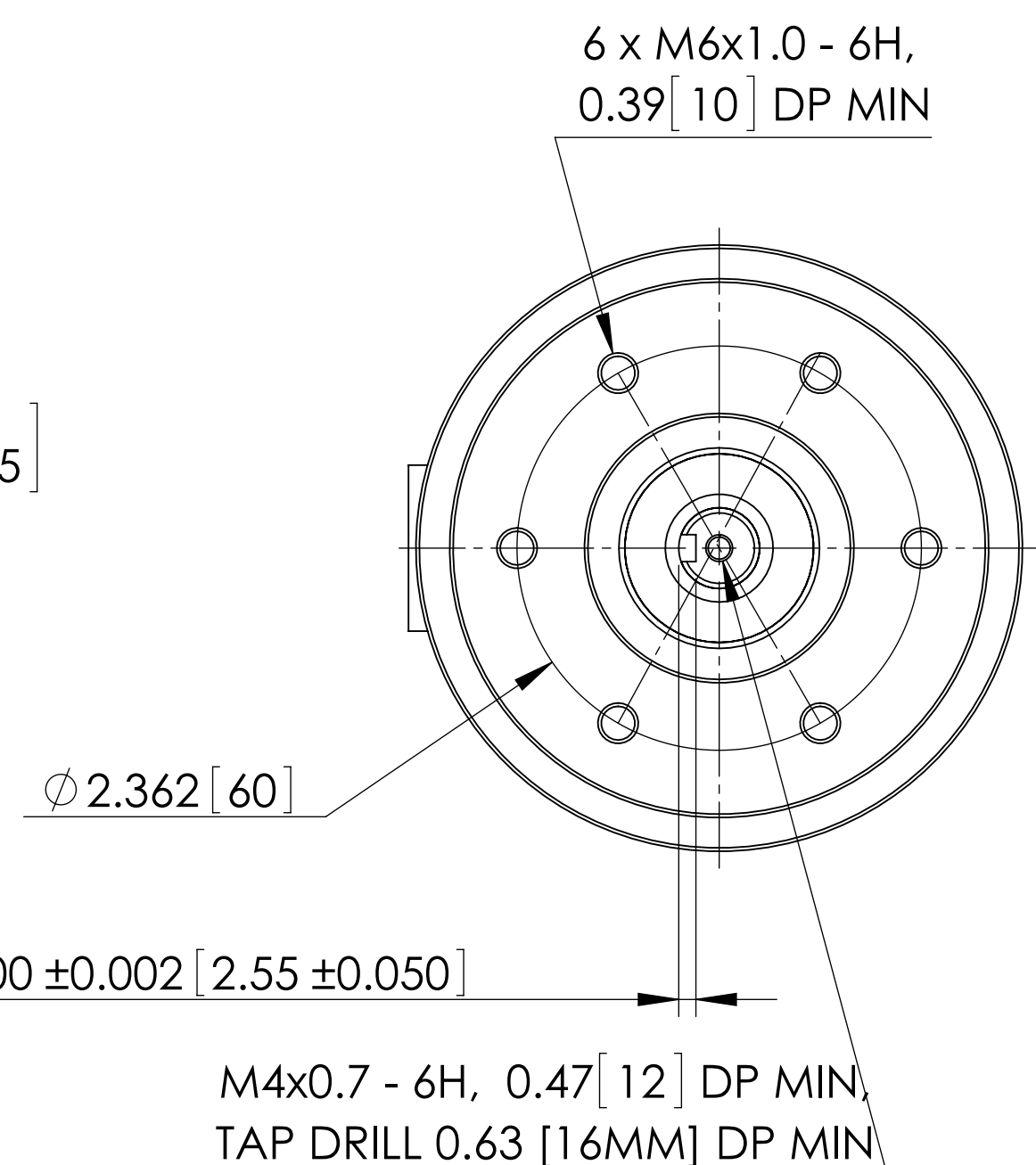
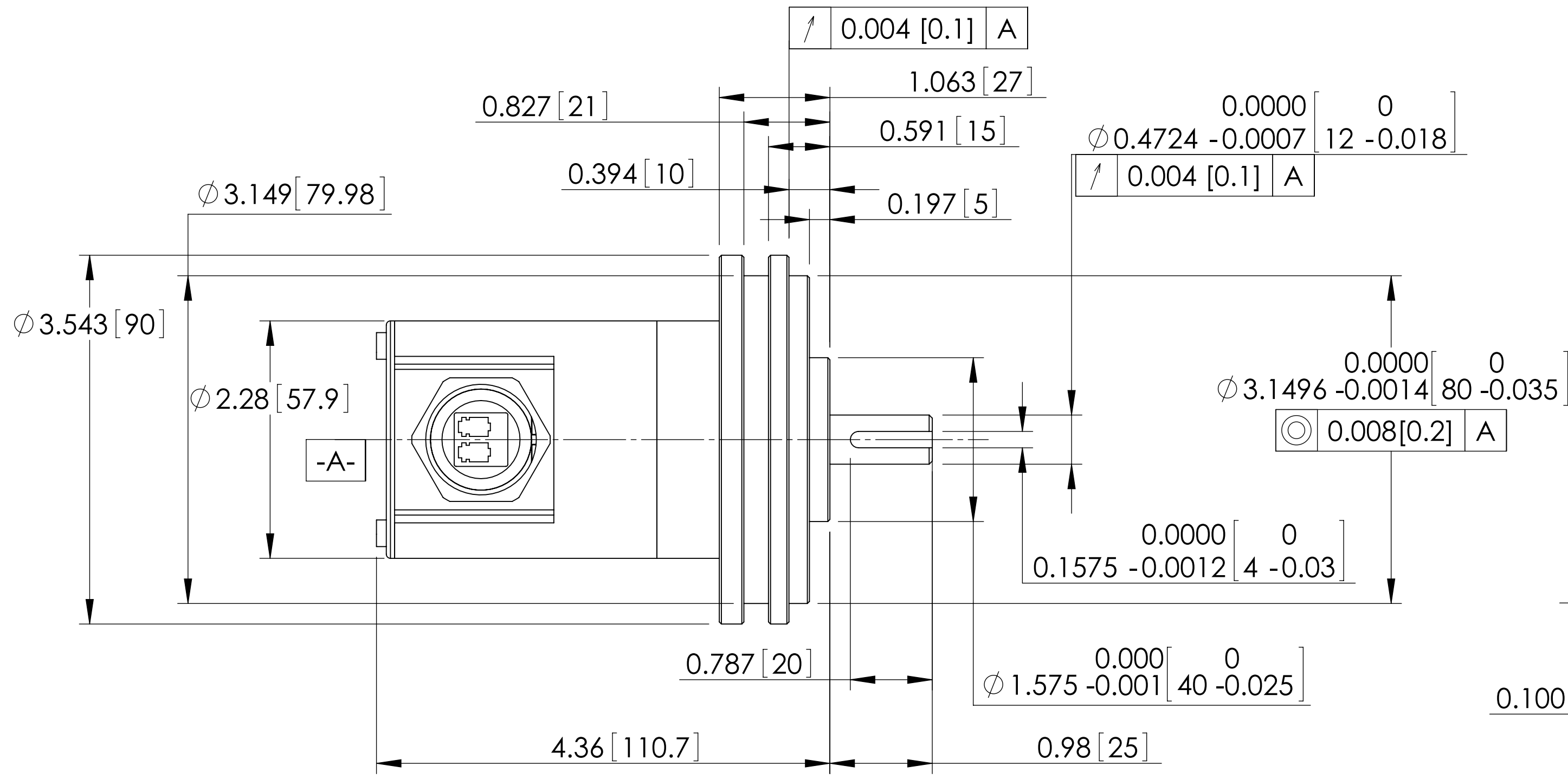

PART NUMBER ORDERING CODE
MR326 - C 12 D00

RESOLUTION
 C = 256

SHAFT SIZE IN MILLIMETERS
 12 = 12MM SHAFT

OPTICAL CONNECTOR
 D00 = INDUSTRIAL LC DUPLEX CONNECTOR

TEMPERATURE RANGE
 (BLANK) = STANDARD (-40 °C TO +80 °C)

- 3 WARNING: KEEP CONNECTOR COVERS IN PLACE DURING STORAGE, TO PROTECT FIBER OPTIC INTERFACES.
- 2 WARNING: DO NOT DROP UNIT. DROPPING OR OTHER SEVERE SHOCK IMPACTS MAY DAMAGE UNIT.
- 1 ALWAYS USE FLEXIBLE COUPLING WHEN MOUNTING SHAFT TO EXTERNAL EQUIPMENT.

NOTES: UNLESS OTHERWISE SPECIFIED

<small>UNLESS OTHERWISE SPECIFIED: DIMENSIONS ARE IN INCHES TOLERANCES: ANGULAR: ± 5° TWO PLACE DECIMAL ± .02 THREE PLACE DECIMAL ± .005 FOUR PLACE DECIMAL ± .0010</small>	DRAWN	R BOYER	6-28-12	MICRONOR INC. NEWBURY PARK, CA (805) 499-0114 TITLE: SENSOR, INDUSTRIAL, 90MM, LC DUPLEX
	CHECKED			
	ENG APPR.			
	MFG APPR.			
<small>INTERPRET GEOMETRIC TOLERANCING PER: MATERIAL FINISH DO NOT SCALE DRAWING</small>	<small>SEE NOTES</small> <small>SEE NOTES</small>	<small>Q.A.</small> <small>COMMENTS:</small>	<small>SCALE: 1:1</small>	<small>REVISIONS</small> SIZE C DWG. NO. MR326-C12D00 REV A