

Preassembled Encoder Cables

M23 connection technology

High Temperature, Twisted Pair



Female connector with coupling nut,
counting direction of the female contacts cw

PE-X cable,
5 x 2 x 0.14 mm² [AWG25] + 2 x 0.50 mm² [AWG20] + shield

Single-ended

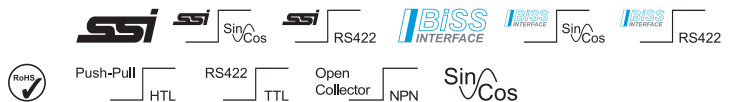

Ordering Code

Order no.

Stock Cables:
DIST-ENC-HT- 15 (15m)

Cable length	1m [3.28']	DIST-ENC-HT- 01	
	5m [16.40']		DIST-ENC-HT-05

	xx m		DIST-ENC-HT-xx
	standard cable length (further on request)	xx = length in meters: 1, 2, 3, 5, 8, 10, 12, 15, 20, 25, 30	

Technical data

Connector material housing protection	DIN M23-12C Zinc diecast / nickel plated IP67
Wire cross sections	5 x 2 x 0.14 mm ² [AWG25] + 2 x 0.5 mm ² [AWG20] twisted pair conductors + shield
Working temperature range flexible installation fixed installation	-25 °C ... +110 °C [-13 °F ... +230 °F] -40 °C ... +135 °C [-40 °F ... +275 °F]
Bending radius cable min. flexible installation fixed installation	90 mm [3.54"] 70 mm [2.75"]
Cable sheath cable diameter approx. material sheath	8.5 mm ±0.9 mm PE-X, halogen-free, chemical resistant

Dimensions in mm [inch]

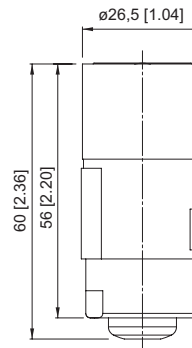

Connections

Terminal assignment

Pin female contacts:	1	2	3	4	5	6	7	8	9	10	11	12
Core color:	PK	BN	BU	RD	GN	YE	-	GY	-	WH 0.5 mm ²	WH 0.5 mm ²	BN 0.5 mm ²

Shield on housing

Plug-in face

CW counting direction, female socket contacts

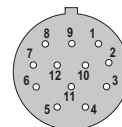

Suitable for our series

Encoders incremental	Encoders singleturn	Encoders multiturn
ESI58HA	ESAX58	ESAM58
ENI58HA	ENAX58	ENAM58
ESI58HT		
ENI58HT		
ESIX50		
ENIX50		